

Oakbrooke Office Building



Offered by R&R Brothers Development
Alex Risser, Manager/Agent
Phone: (757) 377-4628
E-mail: info@RissBro.com
Web site: www.RissBro.com

Location: Area and Subdivision Maps

- 1.25 miles from Chesapeake General Hospital
- 0.75 miles from the Chesapeake Expressway
- 3.5 miles from Interstate 64
- 12 miles from the Port of Virginia's primary marine terminals
- 13 miles from Norfolk International Airport

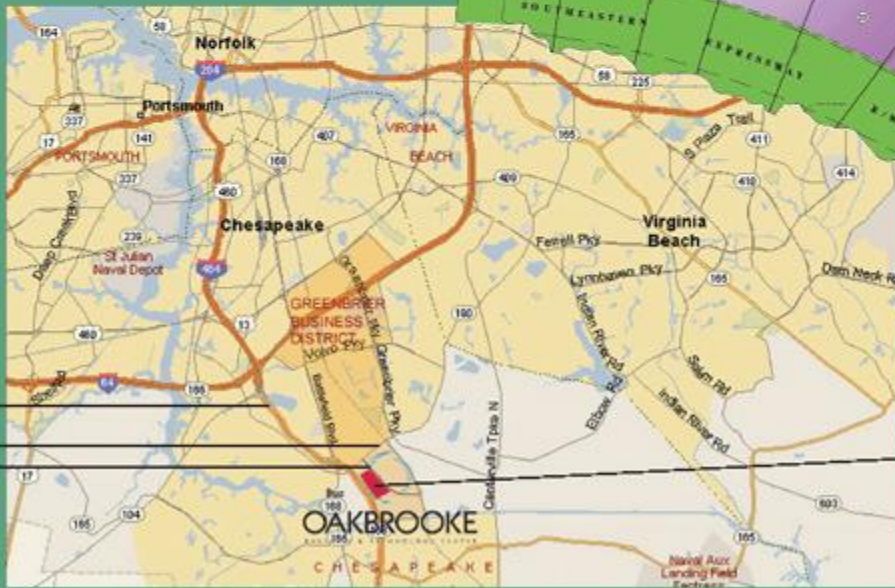

Route 168 -
Chesapeake Expressway
Kempville Road
Clearfield Avenue

Oakbrooke Business &
Technology Center

Building and Technology Specifics

Building Specifics

- 70,000 square feet
- 10,000 square feet per wing, per floor
- 258 total parking spaces
- 2 elevators
- All floors with lake frontage
- Gross lease includes utilities, maintenance and landscaping
- \$18 per square foot Tenant Upfit Allowance

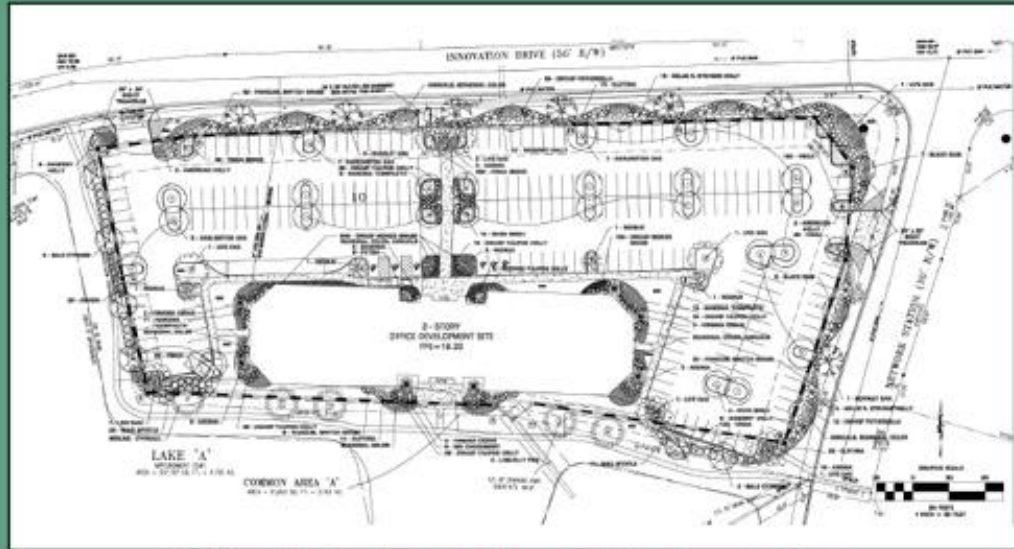

Oakbrooke Development Layout and Landscaping Plan

Technology

- For your business to succeed, effective communication is critical. That includes being securely connected to your employees and the world beyond. At Oakbrooke Business & Technology Center, that connection will be there for you.
- With access to a first-tier optic network, businesses located in Oakbrooke can ensure their telecommunications needs are met. Companies such as Cox Communications and Verizon are among the numerous providers of digital and analog communication services.
- Oakbrooke's business community will also have access to a secure wireless telecommunications network for primary or backup voice and data transmissions. And, since your company will be hiring from one of the "most connected" workforces in the United States, Oakbrooke's public areas will include numerous Wi-Fi hotspots so you can enjoy Chesapeake's great weather and still take care of business on-line.

Office Building Floor Plans

